

LM CLIP 36-450[®]

The standing
seam metal roof-
ing for new buil-
dings and renova-
tion

Made from

Steel

Copper

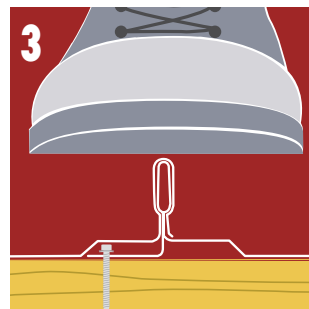
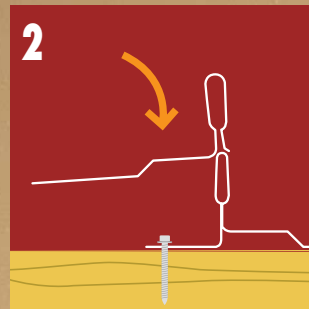
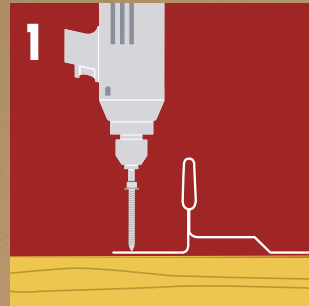

- made on measure
- highly durable
- many standard colours
- absolutely watertight
- no visible fixing spots
- no drilling of the roof sheet necessary

Easy installation
without need of special
tools

1. Screw tight
2. Apply
3. Press firmly



LUXMETALL[®]
for roofing and cladding

LM CLIP 36-450[®]



The standing seam metal roofing for roof and wall cladding

The profiled metal roofing manufactured by LUXMETALL BELGIUM SA are a lightweight, highly sturdy roof and wall covering.

Due to their optimal surface corrugation they are suited both architecturally and aesthetically for industrial and private sector buildings. LUXMETALL standing seam metal roofing is easy to install, highly durable and therefore economical.

The surfaces coated with the advanced Purlux colour coating are able to withstand scratches and shocks which may occur during transport, installation and handling, without any damage to the sheet's base layer.

In addition the surfaces are highly weather-resistant, dirt-repelling (Purlux), corrosion-proof and is guaranteed to maintain its appearance for many years.

BASE MATERIALS

- Steel core ST 37= (AC 280), warm galvanised (Z 275) or aluminium galvanised (AZ 150)
- Copper

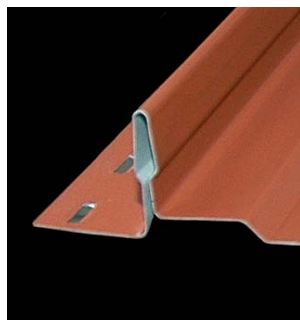

STEEL CORE

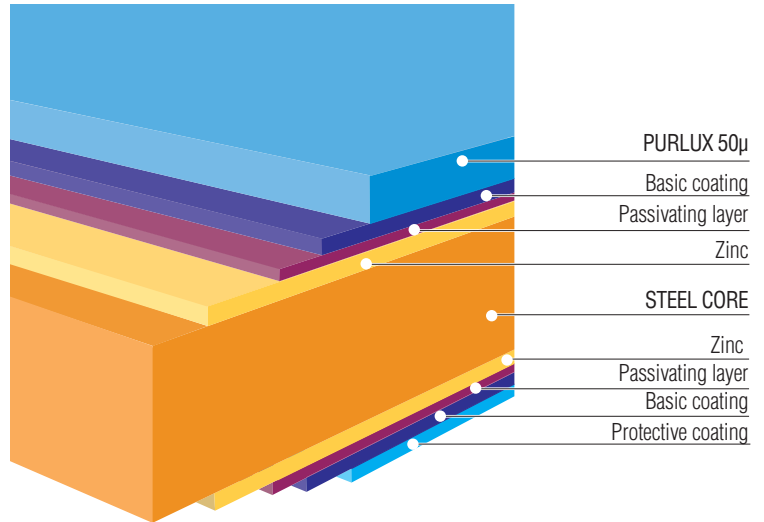

INSTALLATION POSSIBILITIES

For full casing:

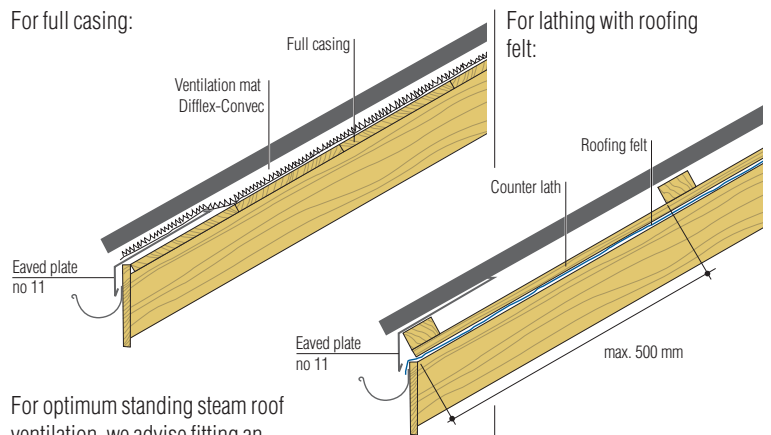

For optimum standing seam roof ventilation, we advise fitting an open-diffusion separation layer such as DIFFLEX-CONVEC (roll width 1000mm) between the full casing and the standing seam metal roofing.

Where no full casing is foreseen, distance between laths should be no more than 500mm.

The Clip 36-450 sheets can be applied in both directions. Screw the sheets tightly to the laths, using the screws and the longitudinal perforations provided. Then fit the next sheet, hook the slits into each other and screw the sheet down tightly ...



Slight pre-tension is specific to the product

TECHNICAL DETAILS

Upon request, we will be glad to supply you with a more detailed description of our products as well as the technical data thereof.

The custom made lengths reduce material waste, time, effort and hence costs during processing.

PLEASE NOTE

Cut:
Never use a grinder !!!

LAYING INSTRUCTIONS

OUTER DIMENSIONS	490 mm
USABLE DIMENSIONS	450 mm
MADE ON MEASURE LENGTHS	1000 - 8000 mm
MINIMUM ROOF PITCH	5.7° = 10%
FASTENING	Clip Fix 4#x35 3 pcs./run. m

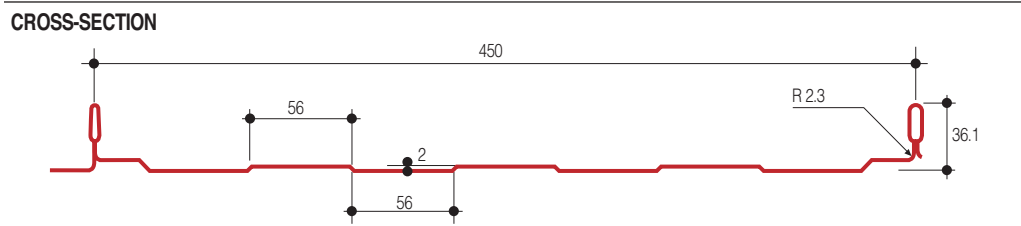

Also available on request without intermediate seams.

MATERIAL	COATING	METAL THICKNESS mm (Weight kg/m²)			
		50 µ	0.50 ● (5.30)	0.60	● (7.28)
STEEL	PURLUX				
COPPER					



Lay the first sheet at right angles to the eaves.



Fix the elements on the sub-structure using the Clip Fix screws provided.



Place the next sheet on the prefabricated seam and clip it in.



Example of a customer solution at the eaves



Transportation on the building site is no problem due to its light weight.



Large roof surfaces are covered very quickly.



The longitudinal correction can be carried out without problems.



Trim the end sheet accordingly. Use a trimmer or similar to do so but never an angle grinder!



Bend the end sheet upwards.



Install the ridge spacing profile No. 28 on every second sheet ...



Screw on the ridge courses with approx. 10 cm of overlap.



Fix the flashing No. 27. Don't forget the sealing compound.



... and your LM Clip seam roof is complete!

LM ACCESSORIES

Along with the standing seam metal roofing we offer a comprehensive line of accessories, such as roof ridges, sealing tapes, screws as well as all necessary safety items. (see our 'Accessories' catalogue)

The usable length is 1800 mm for corrugated material for an accessory length of 2100 mm.



www.luxmetall.com



Quality and reliability since 1990

LUXMETALL BELGIUM SA have been producing profiled sheets and metal roofing tiles since 1990. Millions of square metres of produced and installed profiling are proof of our reliability and experience.

Our products are exported to most European countries and far beyond.

Additionally, they have been thoroughly tested and comply with specific local requirements as defined in numerous countries and locations.



Liability

Given that climatic conditions, legal regulations and work methods may vary from country to country, the data published herein is for information purposes only.

Neither the manufacturer nor the various suppliers can be held responsible for reliability of material or for installation thereof. We accept no liability for damage arising due to faulty storage and/or transportation or as a consequence of unprofessional or incorrect installation.



LUXMETALL®
BELGIUM SA

Z.I., Avenue de Norvège
B-4960 Malmedy
Tel.: +32 (0)80 79 10 70
Fax: +32 (0)80 79 10 71
www.luxmetall.com
E-Mail: info@luxmetall.com

COLOURS

STEEL PURLUX 50 µ (0-10 / 5-50)

BLACK LM 015 P

ANTHRACITE GREY LM 035 P

BRICK RED LM 742 P

BORDEAUX RED LM 747 P

BROWN LM 320 P

GREEN LM 110 P

GREY WHITE LM 9002 P RAL 9002

WHITE ALUMINIUM LM 9006 P RAL 9006

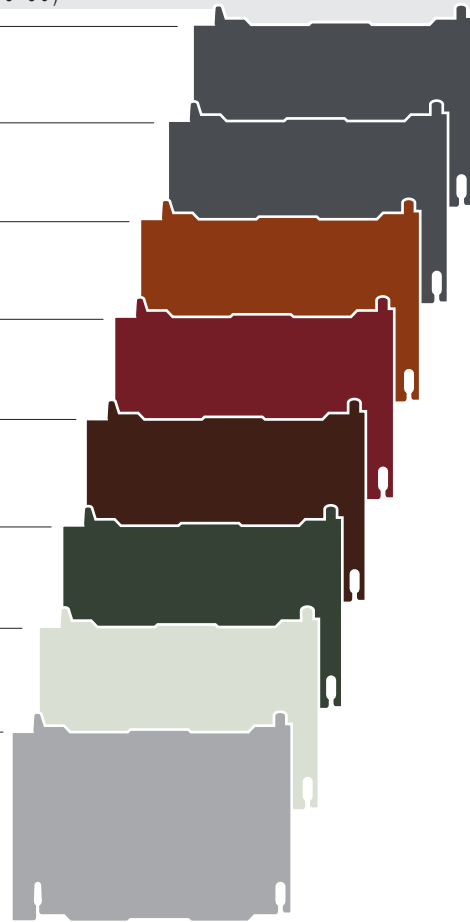

LM recommends:



the coating of the future

- extremely weather resistant
- smooth and therefore dirt-repelling as well as
- scratch and corrosion proof
- available in 8 fashionable colours



Colour shade discrepancies:

The colours shown printed here may differ slightly from the real life PURLUX colours. For this reason, we recommend that you request our genuine colour shade sampler.